

Technical Specifications

MEASUREMENT	
Operating Principle	Constant current
Gases Detected	Most consumable gases & vapours
Measurement Range	0-100% LEL
Maximum Methane Concentration	5% v/v
Output Sensitivity	18.5 ± 3.5 mV/% methane
Response Time	<10 Seconds
Linearity	± 10% LEL over complete range
ELECTRICAL	
Operating Voltage	2.7 ± 0.2 V d.c.
Operating Current	200 ± 1 mA
Maximum Power Consumption	580 mW
POISON RESISTANCE	
Hexamethyldisiloxane	High
Hydrogen Sulphide	High
MECHANICAL	
Can Type	Open
Orientation	Any
ENVIRONMENTAL	
Operating Temperature Range	-40°C to +75°C
Operating Pressure Range	1 atm ± 10%
Operating Humidity Range	0-99% RH non-condensing
Storage Conditions	10-20°C, 45-75% RH in clean air
LIFETIME	
Long Term Zero Drift	< ± 3% LEL methane per year
Long Term Span Drift	< ± 5% LEL methane per year
Shelf Life	6 months in sealed container
Expected Operating Life	Greater than five years
Warranty Period	12 months from the date of dispatch

All dimensions in mm

All tolerances ±0.15mm unless otherwise stated

Poison resistance curve or life test data will be available in the near future.

Poisons and Inhibitors

Poisons : The most common are: Lead or Sulphur containing compounds, Silicones & Phosphates.

Inhibition : The most common are: Hydrogen Sulphide & halogenated hydrocarbons.

The SG16ZA is designed to have a high poison resistance Hexamethyldisiloxane and Hydrogen Sulphide.

Outline Dimensions

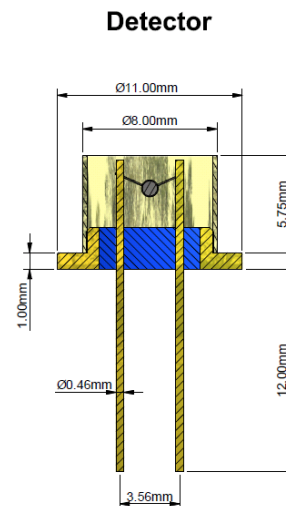
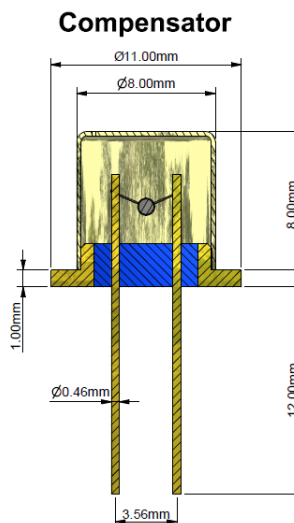

Product Data Sheet

Relative Response Data*

Relative Response Data*			
Gas/Vapour	Relative Response %	Gas/Vapour	Relative Response %
Methane	100	Methanol	79
Hydrogen	89	Ethanol	73
Ethane	85	Propan-2-ol	56
Propane	63	Acetone	58
Butane	54	Butan-2-one (MEK)	55
Pentane	55	MIBK	50
Hexane	55	Iso-Butane	52
Heptane	53	Propylene	65
Octane	39	Toluene	52
Ethylene	77	Xylene	38

*Note: These figures are to be used as a guide only. For greatest accuracy, gas detectors should be calibrated with the target gas. In the interest of product improvement City Technology reserve the right to alter design features and specifications without notice.

The data contained in this document is intended for guidance only and it is the Clients' responsibility to perform any necessary tests to ensure correct performance of this product in specific application for which it is intended. In the interest of product improvement, City Technology reserves the right to alter and amend the product and its performance without notice. As this product may be used by the Client in circumstances outside the control of City Technology, we cannot give any warranty as to the accuracy of these details in any specific application.

